

REV.	ECN NO.	DESCRIPTION	DATE	DESIGN
A		NEW	11/16/09'	蓝荣梅

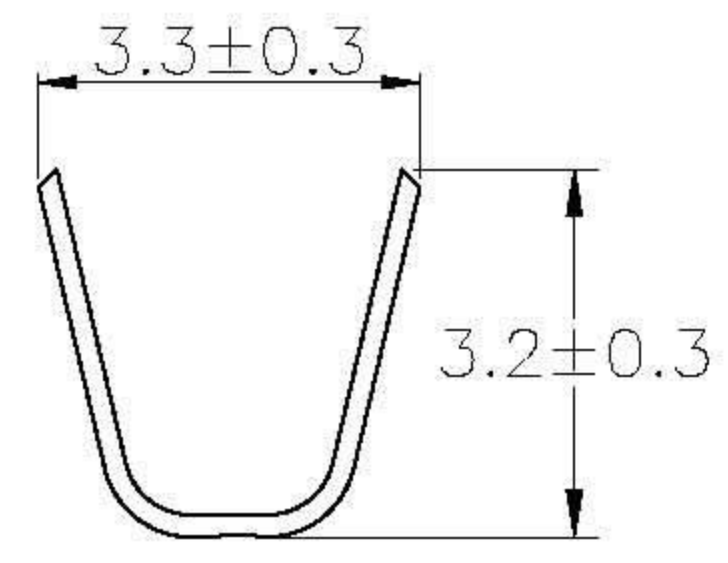

Section A-A

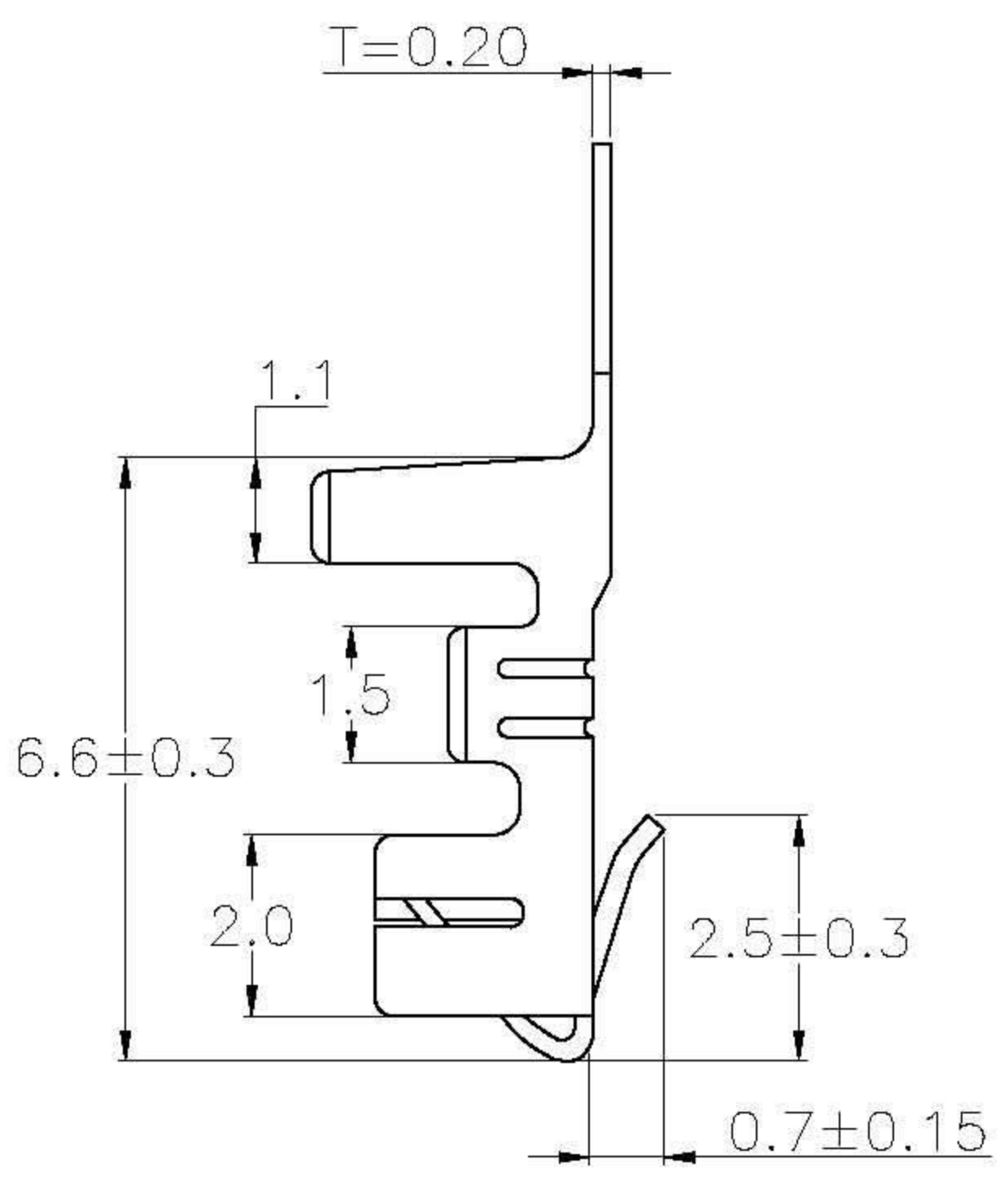
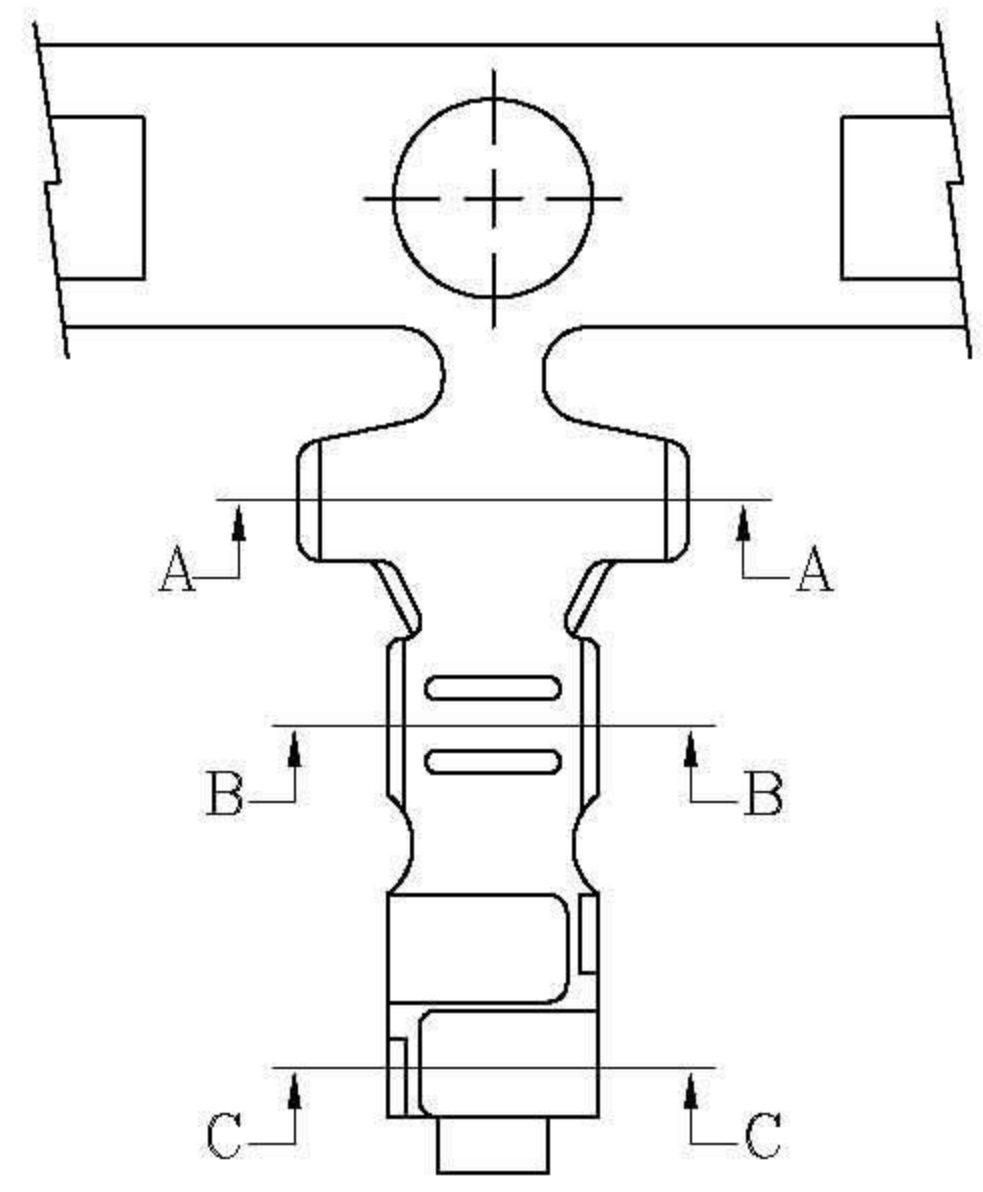
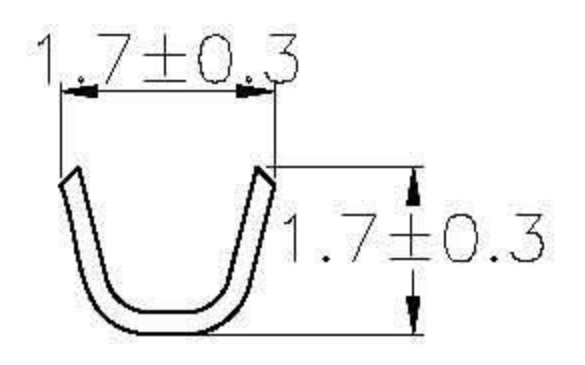

Section B-B

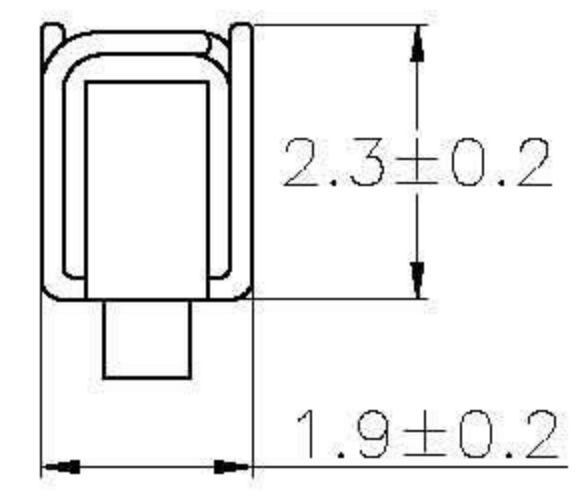

Section C-C

GXCON ENTERPRISE CO., LTD

Specifications & Ordering Information:

WF2501PB	Brass	AWG #22~#30	1.90mm(MAX)	Pating before stamping: Ni/15u*Min.,Sn/65u*Min.	8,000 PCS
WF2501PP	Phosphor Bronze	AWG #22~#30	1.90mm(MAX)	Pating before stamping: Ni/15u*Min.,Sn/65u*Min.	8,000 PCS
PART No	MATERIALS	WIRE RANGE	INSULATION O.D.	FINISH	Qty/reel

DIM	TOL	DIM	TOL
X.X	/	X.X*	/
X.XX	±0.25	X.XX*	±2°
X.XXX	±0.20	X.XXX*	±1°
X.XXX	±0.10	X.XXX*	/

DRAW NO.	DATE	P/N NO:	DRAW NAME:
DESIGN:	11/16/09'	WF2501PB	XH 2.5 Terminal
CHECK:	11/16/09'		
REVIEW:	11/16/09'	REV. A	SCALE 1:1
		UNIT: mm	SHEET: 1 OF 1

